

How to change business modes

EFTPOS Air features multiple modes to better tailor the app to suit your business's needs.

You will be prompted to select your business mode on your first login. You can change modes again by completing the steps below:

1. Tap on the **More** menu.
2. Tap on **Business Mode** from the **Business Settings** menu.
3. From the menu, tap the preferred business mode.
4. Tap **Select This Mode**.

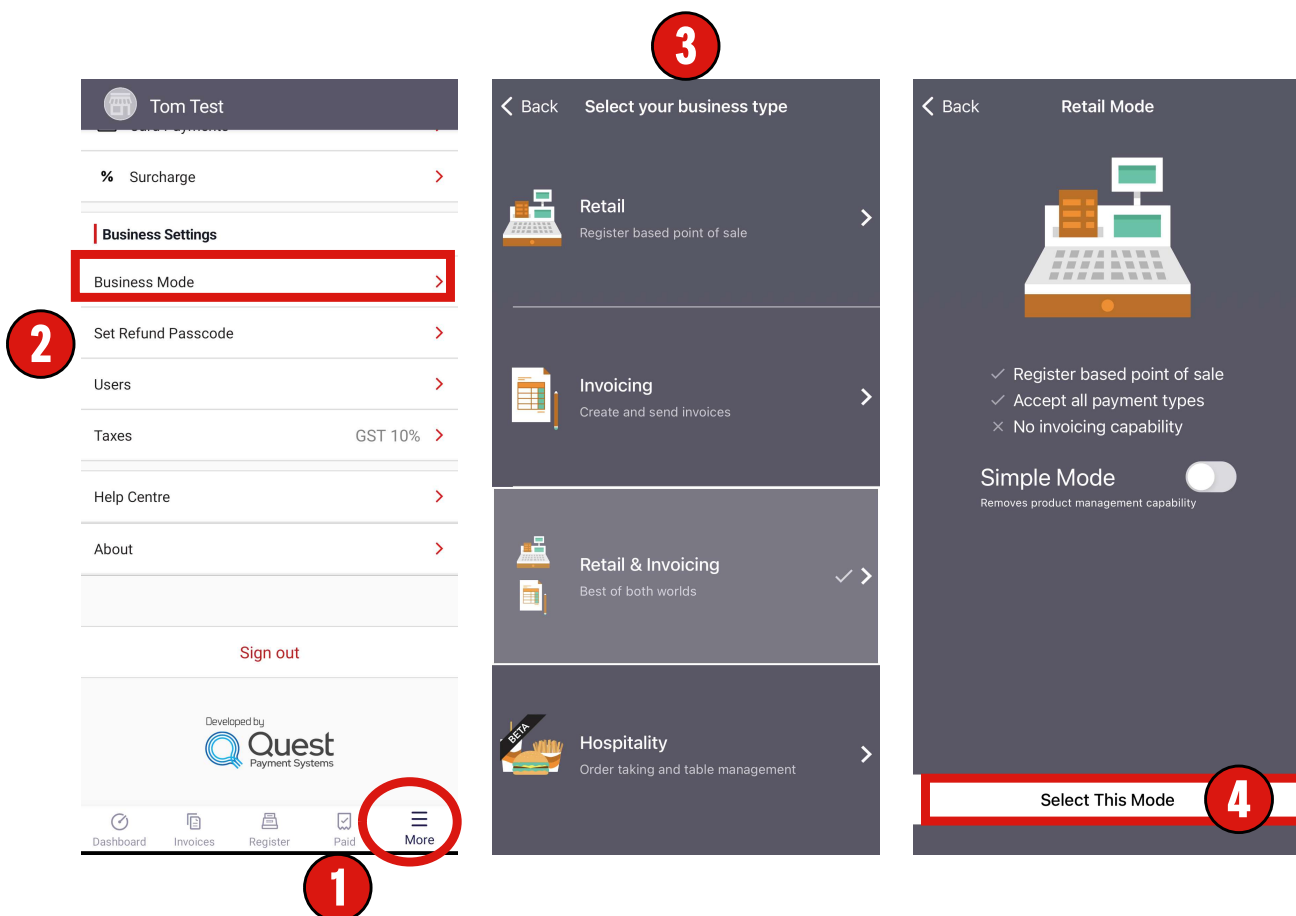

Business Modes

RETAIL (default) mode offers a point of sale (POS) register on your mobile device. It is suited for businesses that make sales on the spot, such as retailers. Retail mode also offers **Simple** mode which will disable product management features and allow for payments only.

RETAIL & INVOICING mode combines both **Retail** and **Invoicing** modes by giving you all the features of both. It is designed for businesses that require the ability to perform POS transactions as well as invoicing customers.

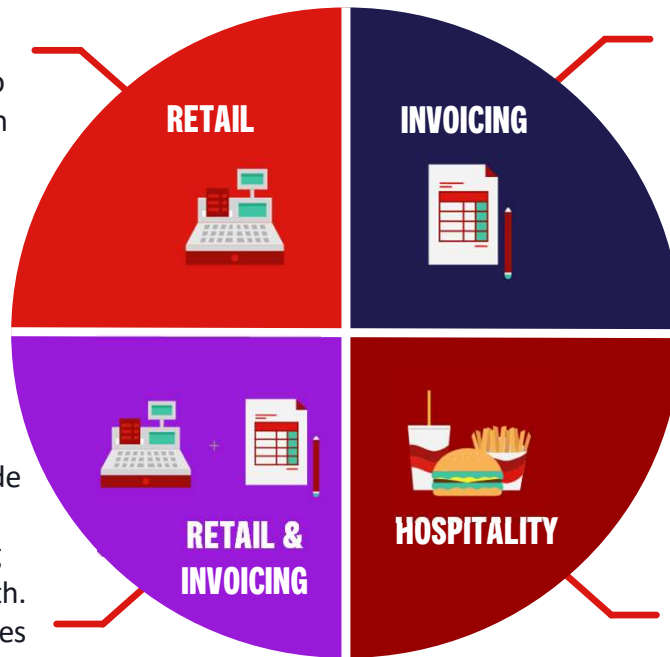

INVOICING mode offers the ability to create and share quotes and invoices with your customers. It is suited for businesses that operate by raising quotes and invoices before taking payments against them.

HOSPITALITY mode is designed for restaurants and cafés. It provides a variation to the POS by offering **orders** and **tables**.

RETAIL	INVOICING
<ul style="list-style-type: none"> • Register-based POS • Sell and manage the items you sell • Custom amounts for ad-hoc sales 	<ul style="list-style-type: none"> • Raise and send invoices to your customers • Sell and manage the items you sell • Set custom amounts for ad-hoc sales
RETAIL & INVOICING	HOSPITALITY
<ul style="list-style-type: none"> • Register-based POS • Raise and send invoices to your customers • Sell and manage the items you sell • Set custom amounts for ad-hoc sales 	<ul style="list-style-type: none"> • Table management • Register-based POS • Sell and manage the items on your menu • Set custom amounts for ad-hoc sales

